



CALIFORNIA  
ACCENT  
LIGHTING  
INC

# ML2000-CM | STRING LIGHTS

## PROJECT

## TYPE



## END VIEW

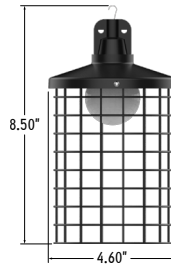

Canopy M  
(ML2000-CM)

## ACCESSORIES (Sold Separately)

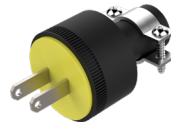

Power Plug  
(ML2000-PP)



End Cap  
(ML2000-EC)

## LAMP SPECIFICATIONS

LAMP NUMBER	CORRELATED COLOR TEMPERATURE	COMPATIBLE SHAPES
2.4K	2400K Incandescent White	GSFL
2.7K	2700K Warm White	GSF, GSFL, SSF, SSC
3.0K	3000K Warm White	GSFL
5.0K	5000K Cool White	GSF, GSFL, SSF, SSC
A	Amber	SSC, GSF
R	Red	SSC, GSF
G	Green	SSC, GSF
B	Blue	SSC, GSF

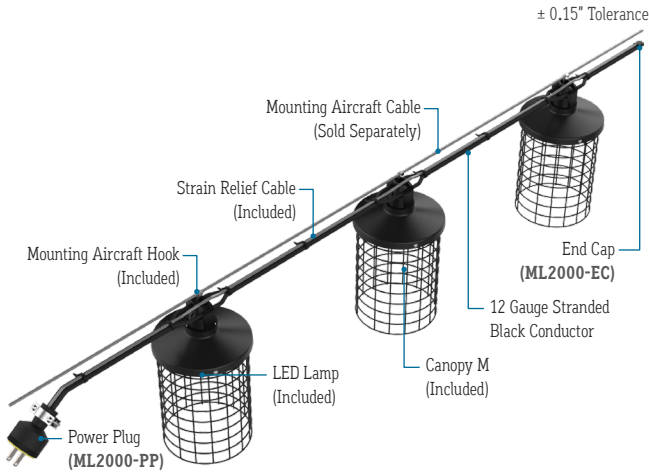

## FEATURES

APPLICATIONS	Indoor and Outdoor
LAMP	LED Lamp (Included)
LED LAMP LIFE	20,000 Hours
LENGTH	Built to Order
FINISH	Black
FEED	Standard 6' Power Lead
STRAIN RELIEF	Cable (Included, Not for Mounting)
MOUNTING	Mounting Aircraft Cable (Sold Separately)
LISTING	Dry or Wet Location ANSI/UL1598 CSA 22.2 No. 250.0-04, 2nd Edition
OPTIONS	Mesh, Canopies, or Cages
UV RATING	Sun Light Resistance
BUG RATING	B0-U2-G1 Dark Sky Compliant <sup>*1</sup>
INSTALLATION	Link to Installation Instructions
ELECTRICAL	
DIMMING	Forward Phase
MAXIMUM RUN	100'
VOLTAGE	120V
SYSTEM	20 Amps (12 Gauge Wire)
WATTS	1W or 3W Lamps

SERIES	SPACING	LAMP	DIMMING	LISTING	CANOPY FINISH <sup>*2</sup>	FIXTURE LENGTH
ML2000-CM	-	-	-	-	-	-
ML2000-CM	12" O/C (12")	2.7K-GSF 5.0K-GSFL	Forward Phase (DM)	Indoor (DRY)	Natural (NA)	Specify Length in Feet Example: 100'
	18" O/C (18")	5.0K-GSF 2.7K-SSF	Leave Blank for Non-Dimming	Outdoor (WET)	Polished (PA)	
	24" O/C (24")	A-GSF 5.0K-SSF			White (WH)	
	36" O/C (36")	R-GSF 2.7K-SSC			Black (BK)	
	48" O/C (48")	G-BSF 5.0K-SSC			Green (GN)	
	60" O/C (60")	B-GSF A-SSC			Bronze (BR)	
		2.4K-GSFL R-SSC			Silver (SR)	
		2.7K-GSFL G-SSC			Red (RD)	
		3.0K-GSFL B-SSC				

<sup>\*1</sup> For Dark Sky Compliant fixtures, use only 2.4K, 2.7K, or 3.0K LEDs

<sup>\*2</sup> Standard Canopy Finish: Black (BK) if unspecified

## CALIFORNIA ACCENT LIGHTING, INC.

2820 E. Gretta Lane, Anaheim, CA 92806

ph. 800.921.CALI (2254) | fx. 714.535.7902 | info@calilighting.com | calilighting.com

© CALI. All rights reserved. CALI reserves the right to make changes or withdraw specifications without prior notice.

marketLITE<sup>TM</sup>  
Manufactured in the U.S.A.



## LAMP OPTIONS

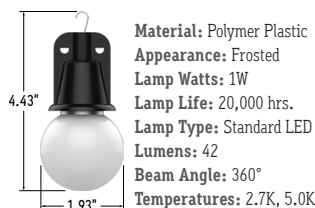

G Shape  
(GSF)

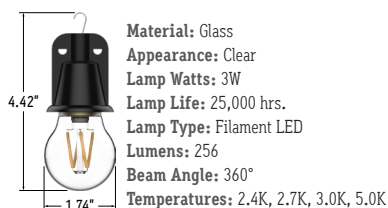

Filament G Shape  
(GSFL)

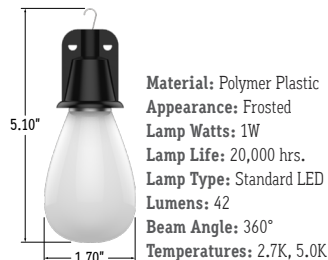

S Shape  
(SSF)

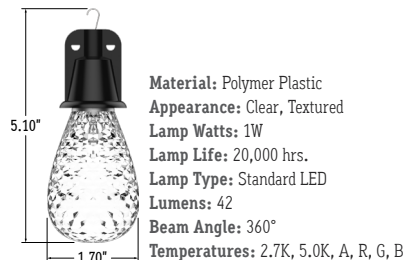

S Shape  
(SSC)

## MOUNTING ACCESSORIES

(Sold Separately - Click on Image to View Cut Sheet, If Applicable)

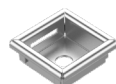

Mounting Plate  
(ML2000-MP)



Cable Lock  
(ML2000-CL-1/8")



Mounting Aircraft Cable  
(ML2000-AC-1/8"-X) X = Specify Length  
Specify 50' increments up to 500' per reel.

## INSTALLATION RECOMMENDATIONS

- Determine weight of marketLITE that will be used.
- Determine length of marketLITE and multiply by weight.
- An engineer must choose the proper aircraft cable to handle the tension, based on length and weight to prevent product from sagging.
- An engineer must determine the strength of the structure where the cable will attach, based on tension calculation from previous step.
- If installing on a pole, check with pole manufacturer to confirm the pole can handle the tension.
- marketLITE is hung to the above aircraft cable using the hooks. Secure hooks to aircraft cable by crimping or using stainless steel tie wraps.
- The supplied aircraft cable is designed to prevent strain on the wire. An additional aircraft cable is required to hang marketLITE.

## HARDWARE INSTALLATION

(Wet Location)

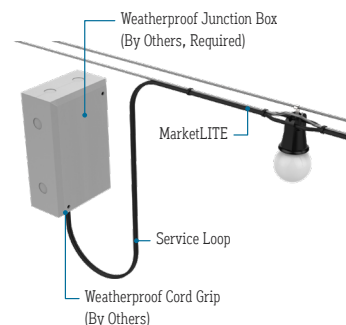

## POWER PLUG

(Wet Location)

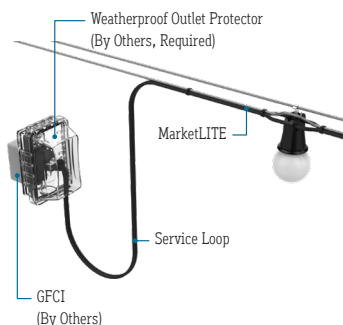

## WEIGHT PER FOOT

SERIES	SPACING	WEIGHT
ML2000-CM	12" O/C	0.79 lbs per foot
	18" O/C	0.56 lbs per foot
	24" O/C	0.45 lbs per foot
	36" O/C	0.34 lbs per foot
	48" O/C	0.29 lbs per foot
	60" O/C	0.25 lbs per foot

## DESIGN GUIDELINES

Straight Run



Swayed Run



## INSTALLATION OPTIONS

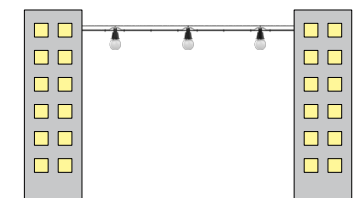

Building to Building

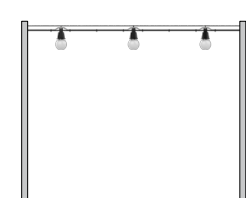

Pole to Pole

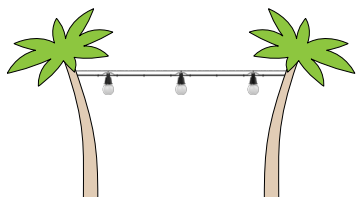

Tree to Tree

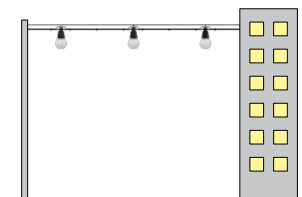

Building to Pole

## CALIFORNIA ACCENT LIGHTING, INC.

2820 E. Gretta Lane, Anaheim, CA 92806

ph. 800.921.CALI (2254) | fx. 714.535.7902 | info@calilighting.com | calilighting.com

© CALI. All rights reserved. CALI reserves the right to make changes or withdraw specifications without prior notice.

**marketLITE™**  
Manufactured in the U.S.A.

